

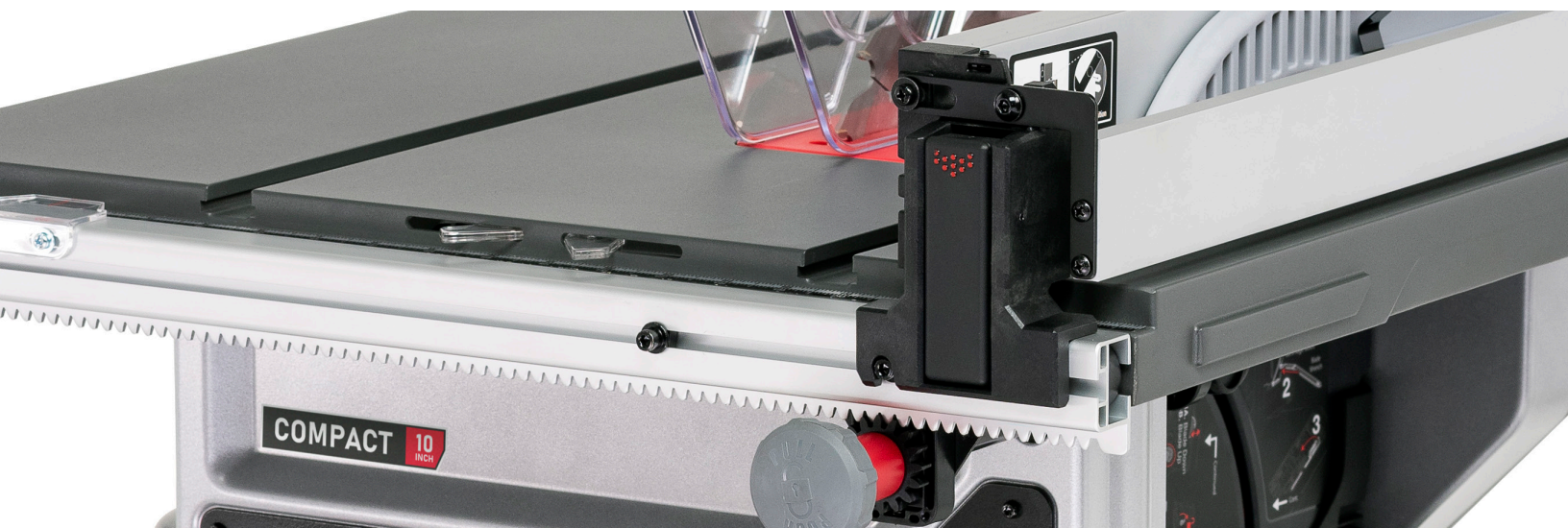

SERVICE DOCUMENT

CTS Puck Adjustment Procedure

November 2022



Compact Table Saw Puck Adjustment Procedure

Your Compact Table Saw is designed with integrated adjustment hardware to trim and true the fence and fence rails through their full range of extension. The following instructions cover how to adjust the fence guides (“pucks”) for optimal performance at all fence positions including at full extension.

Required Tools:



M3 Allen Wrench



Locking Pliers



24" or longer Straight Edge

Part 1: Assessment

1) Install the fence on the right side of the CTS rail system.

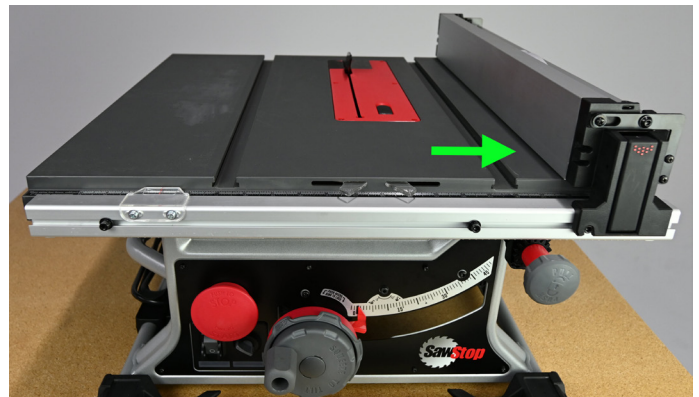

2) Unlock the fence rails by pulling out the control knob.

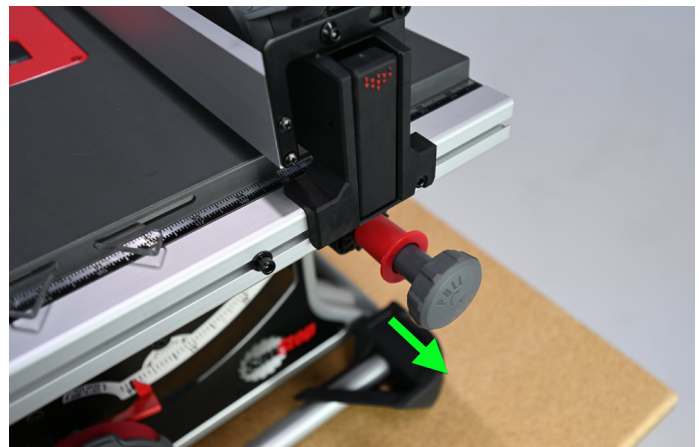

3) Extend the fence adjustment to the fully extended, 24 1/2" position.

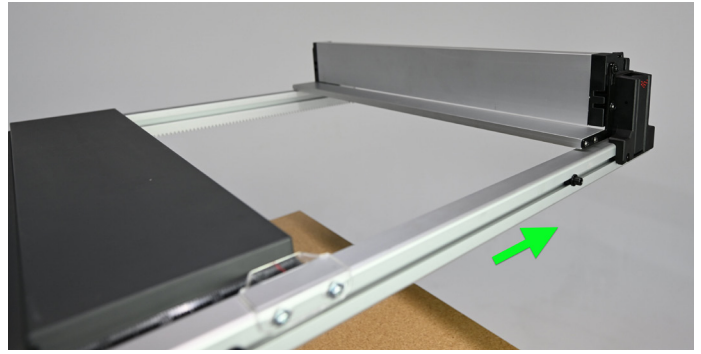

4) Lock the fence rails by pushing in the control knob



5) Using a 3mm Allen wrench, loosen the bolt from below the center guide adjustment as shown.

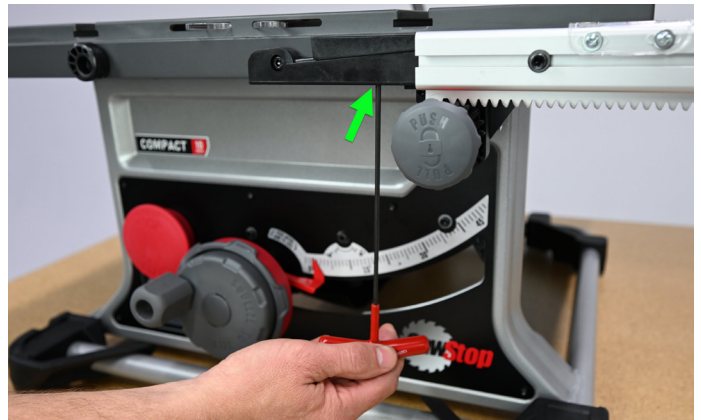

Note that the upper portion of this guide is now moveable. Slide this adjustment left (to its shortest position) and lightly re-snug the bolt for now. You'll finalize this adjustment later in Part 3 of this document. Perform this step for the center guide at both the front and rear of your CTS.

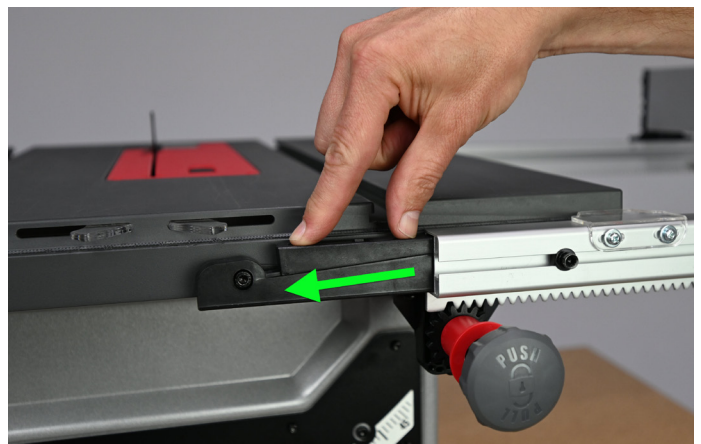

6) Remove the accessory tray from the rear of your CTS as shown. The bolt at the underside of center guide on the rear of the saw is now accessible. Repeat the adjustment described in Step 5 for the front of the saw on the center guide at the rear of the saw as well.

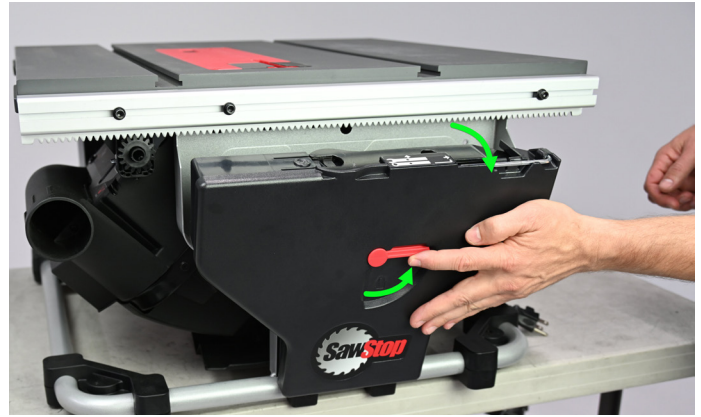

7) Put the Low Fence into the shelf position as shown. ([Refer to your Compact Table Saw Owner's Manual for instructions.](#))

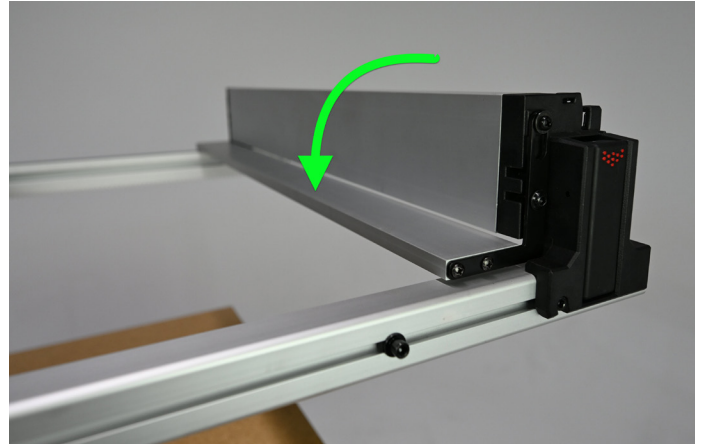

8) Hold straight edge firmly against the surface of the table with the other end extended over the shelf as shown.



9) Note the gap between the straight edge and the shelf. If you would like to reduce the gap, use the Part 2 instructions below.

- The guides ("pucks") for both front and rear fence rails are independently adjustable so check the gap with the straight edge near the front rail and again near the rear rail.



Part 2: Adjustment for Far End of Fence Rails

CAUTION: To ensure complete understanding of this process, please read and understand all the instructions before making any adjustments.

- 1) Return the low fence to its storage position. Next, move the fence rails to the left-most position. This will expose the right side, circular pucks.

Note the geometry of the circular puck and that the location of the bolt that attaches it to the edge of the saw table is off-center. Also note that the portion of the puck with the pattern of holes at its perimeter is biased outward and facing away from the center of the saw. As you make the adjustments described below, be sure to not completely invert this orientation.

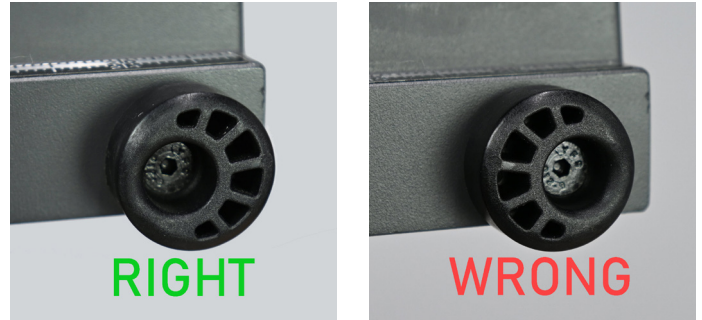

As seen from the right-front corner of the saw.

- 2) Begin at the front of the saw and adjust the circular puck at the right. Protect the puck from the jaws of the pliers as shown. Use the pliers to rotate the puck.

NOTE: Small adjustments to the pucks make a big impact on the rail alignment so proceed judiciously making only tiny corrections.



- a. Adjust the puck in the counterclockwise direction if you found the low fence to be resting below the saw table when you checked for drop near the front. This will raise the far end of the fence rail when fully extended.
- b. Adjust the puck in the clockwise direction if you found the low fence to be resting above the saw table when you checked for drop near the front. This will drop the far end of the fence rail when fully extended.



As seen when facing the front of the CTS, note that only the right side circular pucks should be adjusted for this procedure. Do not adjust the other set of circular pucks.

- 3) Next adjust the exposed circular puck at the rear of the saw. It will be located to your left when facing the rear of the saw.
 - a. Adjust the puck in the clockwise direction if you found the low fence to be resting below the saw table when you checked for drop near the front. This will raise the far end of the fence rail when fully extended.
 - b. Adjust the puck in the counterclockwise direction if you found the low fence to be resting above the saw table when you checked for drop near the front. This will drop the far end of the fence rail when fully extended.
- 4) Return to the Assessment section above and re-check for drop.
- 5) This is an iterative process. Repeat steps 2-4 as needed until the drop between table and shelf is adjusted to your satisfaction. As indicated, both front and rear pucks should be adjusted between assessments.

Part 3: Adjustment for Vertical Play of the Fence Rails

Early in this procedure, the center guides at both the front and rear of the saw were set to their lowest position. If you haven't already performed this step, do so before proceeding with the instructions below. The following steps will optimize the stacked pair of center fence rail guides to minimize upward play in the fence rails.

CAUTION: To ensure complete understanding of this process, please read and understand all the instructions before making any adjustments.

1) Install the fence on the right side of the CTS rail system.

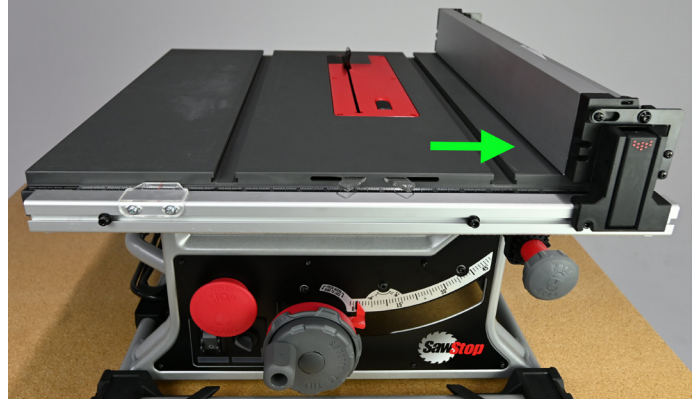

2) Unlock the rail by pulling out the rail lock knob.

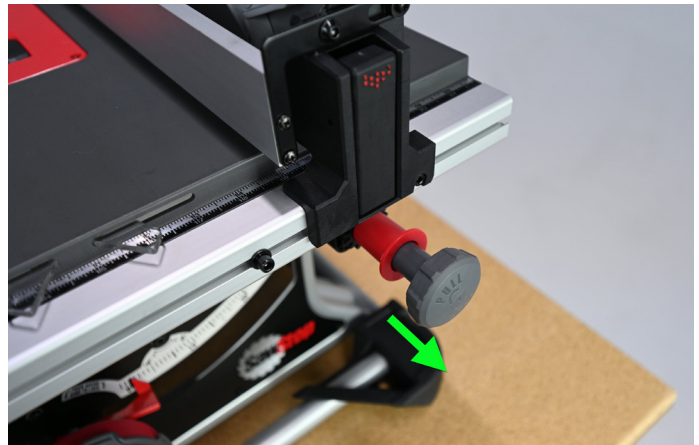

3) Extend the fence adjustment to the fully extended, 24 1/2" position.

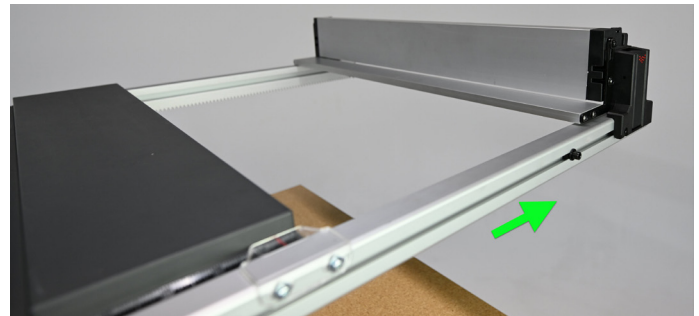

4) Lock the fence rails by pushing in the control knob

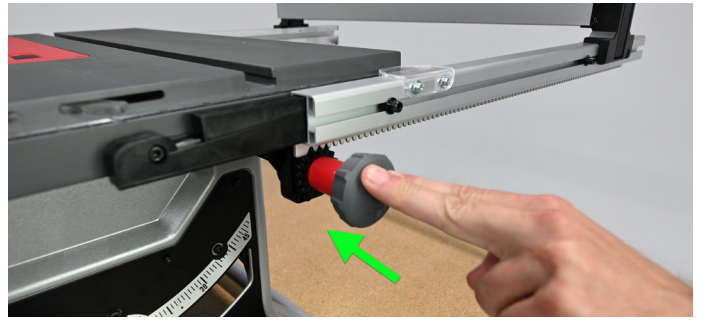

5) Using a 3mm Allen wrench, loosen the bolt from below the center guide adjustment as shown. Note that the upper portion of this guide is now moveable.

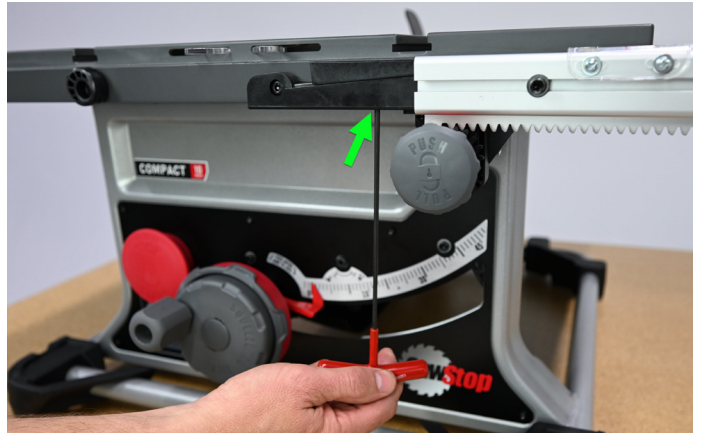

6) Slide the upper portion of the guide to the right to increase the combined height of the upper and lower guides. Secure the bolt when you've approximated the placement needed to minimize the upward play in the fence rails.

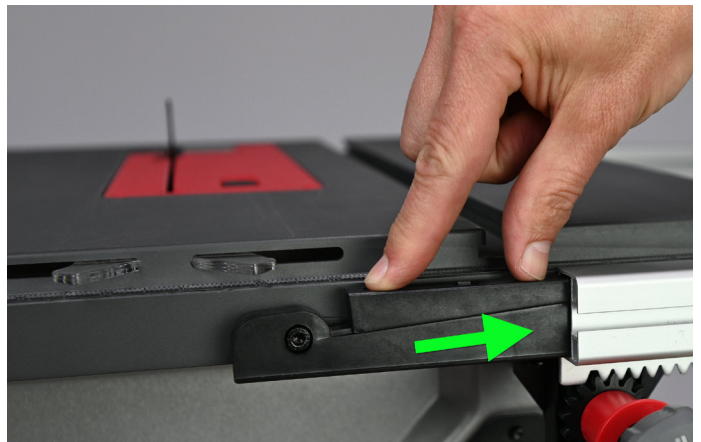

7) Repeat steps 5 and 6 for the center fence rail guide at the rear of your CTS.

8) Test this adjustment by cycling the fence rails through their full range of travel using the adjustment knob.

9) If excessive upward motion in the fence rails persists, repeat steps 5 – 7 as needed.

NOTE: A measure of play between the guides (pucks) and rail is necessary for smooth operation of the fence positioning feature of your CTS. If the fence positioning requires too much force, back off the engagement of the upper portion of the center guide. Some upward motion of the fence rails is expected and should not affect cut quality.



SAWSTOP SERVICE

503-582-9934
8 am - 5 pm PST
Monday - Friday

Service@SawStop.com